

# Ferrite Cores

## P9/5 to P30/19 Series

For Power Supply and Signal Transformer  
Pot Cores

### CORE SHAPES AND DIMENSIONS/CHARACTERISTICS

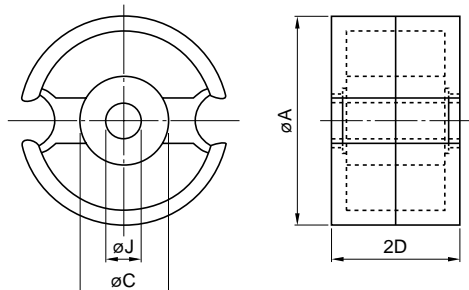

• These cores are designed based on IEC Pub.133

Type	Dimensions (mm)				Ae (mm <sup>2</sup> )	le (mm)	Weight (g)	Bobbin*	Clamp
	$\phi A$	$\phi C$	2D	$\phi J$					
P9/5	9.3+0, -0.3	3.9+0, -0.2	5.4+0, -0.2	2+0.1, -0	10	12.4	0.8	BP9/5-612	FP9/5-6B
P11/7	11.3+0, -0.4	4.7+0, -0.2	6.6+0, -0.2	2.1+0.1, -0	16	15.5	1.8	BP11/7-612, 622	FP11/7-6B
P14/8	14.2+0, -0.4	6+0, -0.2	8.5+0, -0.3	3+0.2, -0	25.1	19.8	3.2	BP14/8-612, 622	FP14/8-6C
P18/11	18.2+0, -0.6	7.6+0, -0.3	10.7+0, -0.3	3+0.2, -0	43.3	25.8	6.7	BP18/11-612, 622, 632	FP18/11-6C
P22/13	21.6±0.4	9.4+0, -0.3	13.6+0, -0.4	4.4+0.3, -0	63.4	31.5	12.7	BP22/13-612, 622, 632	FP22/13-6C
P26/16	25.5±0.5	11.5+0, -0.4	16.3+0, -0.4	5.4+0.3, -0	94	37.6	21	BP26/16-612, 622, 632	FP26/16-6C
P30/19	30±0.5	13.5+0, -0.4	19+0, -0.4	5.4+0.3, -0	137	45.2	35	BP30/19-612, 622, 632	FP30/19-6C

\* -612: Non-sectional bobbin, -622: 2-sectional bobbin, -632: 3-sectional bobbin

### ELECTRICAL CHARACTERISTICS

#### WITHOUT AIR GAP

Part No.	AL-value (nH/N <sup>2</sup> )[1kHz, 0.5mA, 100Ts]
H5AP9/5Z-52H	1570±25%
H5C2P9/5Z-52H	6030±30%
PC40P9/5Z-52H	825min.
H5AP11/7Z-52H	2320±25%
H5C2P11/7Z-52H	8220±30%
PC40P11/7Z-52H	1250min.
H5AP14/8Z-52B	3000±25%
H5C2P14/8Z-52B	11300±30%
PC40P14/8Z-52B	1610min.
H5AP18/11Z-52B	4500±25%
H5C2P18/11Z-52B	16000±30%
PC40P18/11Z-52B	2400min.
H5AP22/13Z-52H	5900±25%
H5C2P22/13Z-52H	19500±30%
PC40P22/13Z-52H	2990min.
H5AP26/16Z-52H	7800±25%
H5C2P26/16Z-52H	24500±30%
PC40P26/16Z-52H	3810min.
H5AP30/19Z-52H	9800±25%
H5C2P30/19Z-52H	32000±30%
PC40P30/19Z-52H	7300±25%

#### WITH AIR GAP

Part No.	AL-value (nH/N <sup>2</sup> )[1kHz, 0.5mA, 100Ts]
PC40P9/5AXXX*-52H	63±3%, 100±3%, 160±5%
PC40P11/7AXXX*-52H	63±3%, 100±3%, 160±3%
PC40P14/8AXXX*-52B	100±3%, 160±3%, 250±3%
PC40P18/11AXXX*-52B	100±3%, 160±3%, 250±3%
PC40P22/13AXXX*-52H	100±3%, 160±3%, 250±3%
PC40P26/16AXXX*-52H	160±3%, 250±3%, 400±3%
PC40P30/19AXXX*-52H	250±3%, 400±3%, 630±3%

\* XXX: AL-value